

---

## How to setting and testing the printer's black mark function.

Prerequisite: the computer has installed the printer driver already.

Operation Notice:

1. To set up the port in the Printer Properties, exe: COM1.

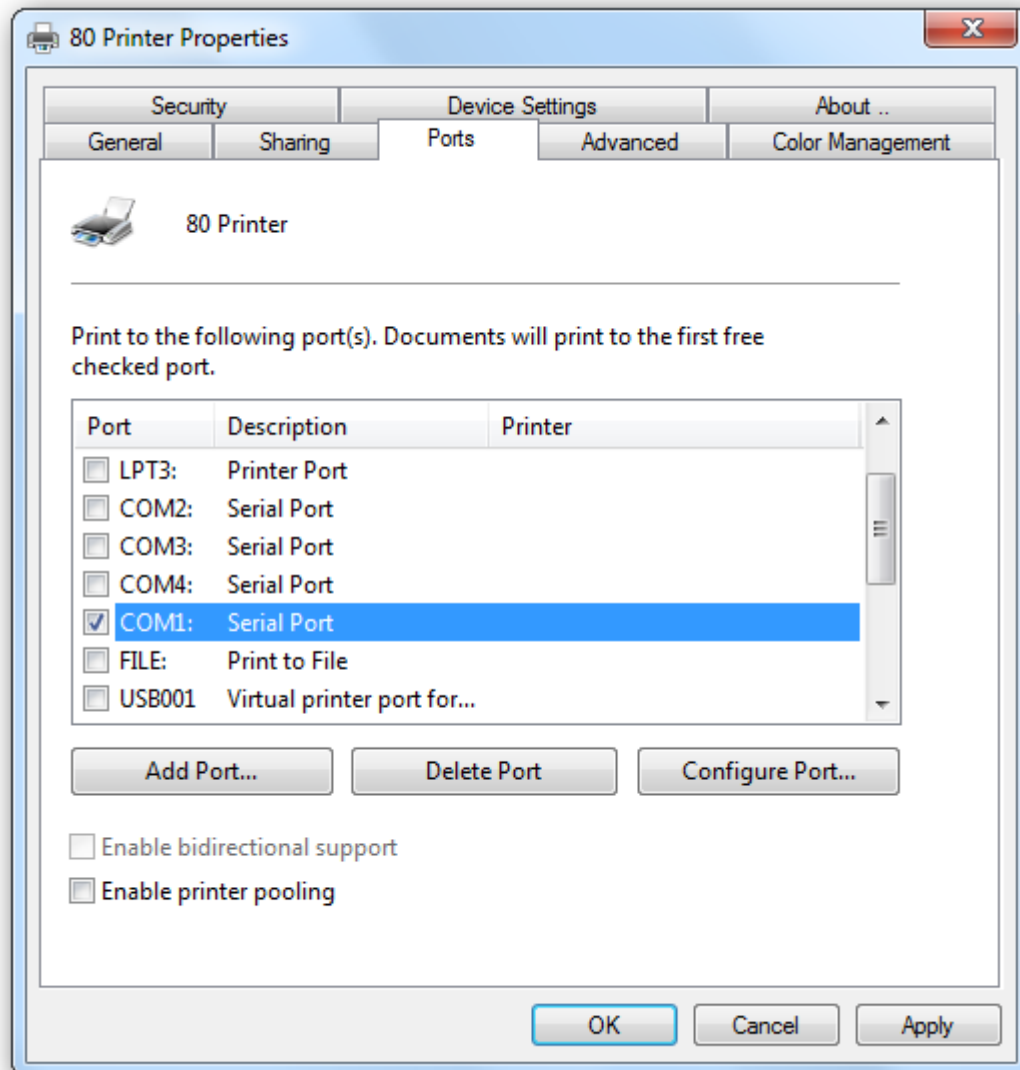

2. Open black demo.exe and choose the printer which has been set up the port.

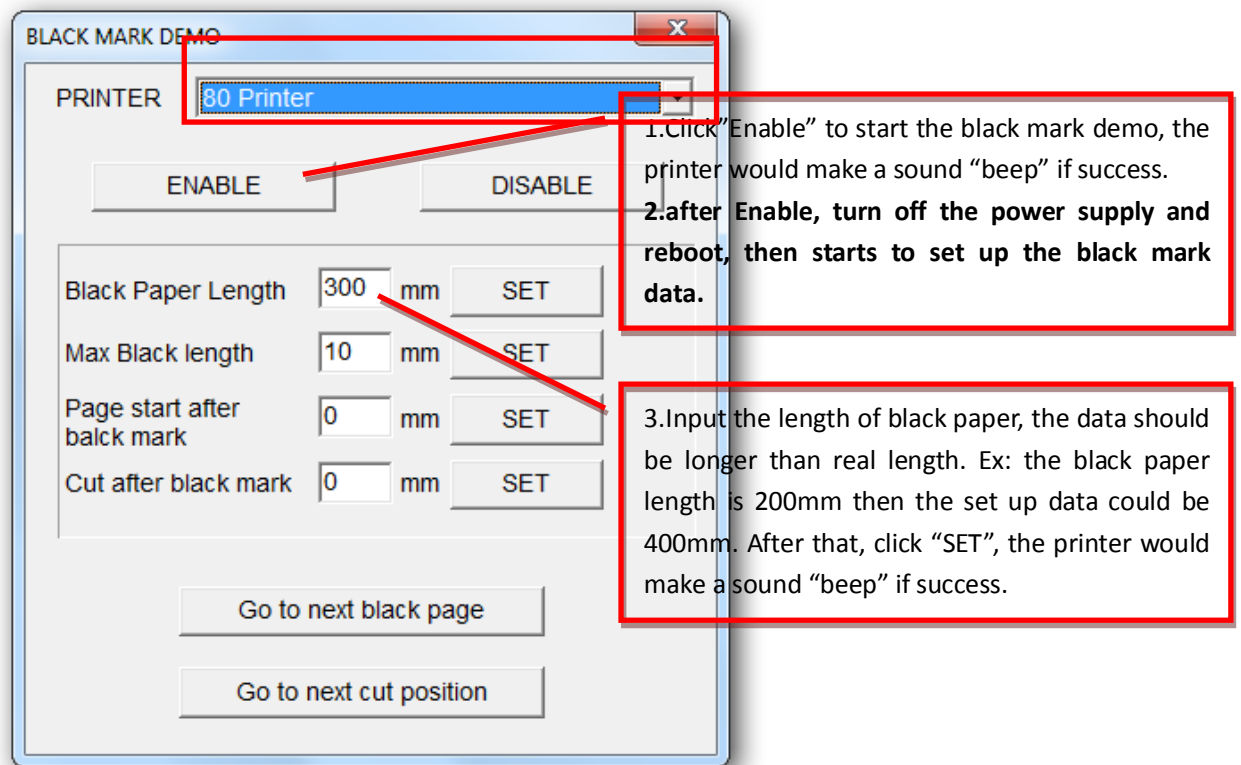

### 3. Install and test instruction

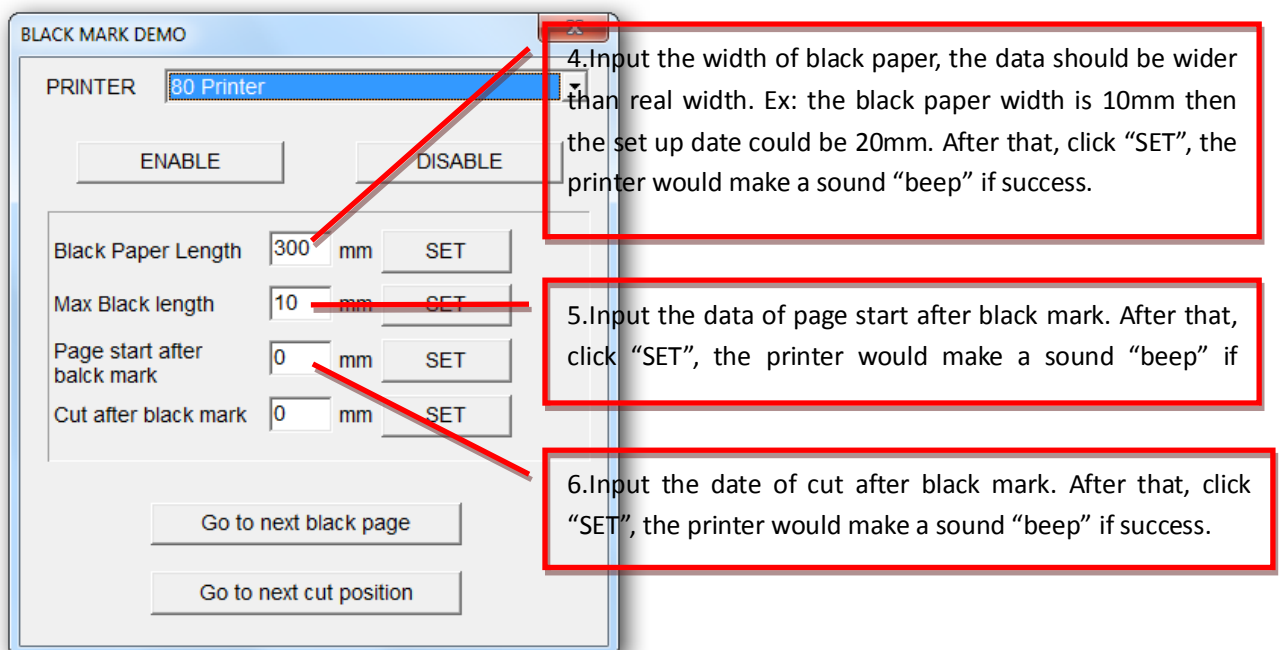

After the setting of black mark data, please click "Go to next black page" and "Go to next cut position" to check the black page and cut position.

4. Please close the black mark function if use the thermal paper that without it. Otherwise, the printer would make error because it could not search for the black mark. The printer would make a sound "beep" for eight times if the function of black mark is wrong.